

Установочные размеры

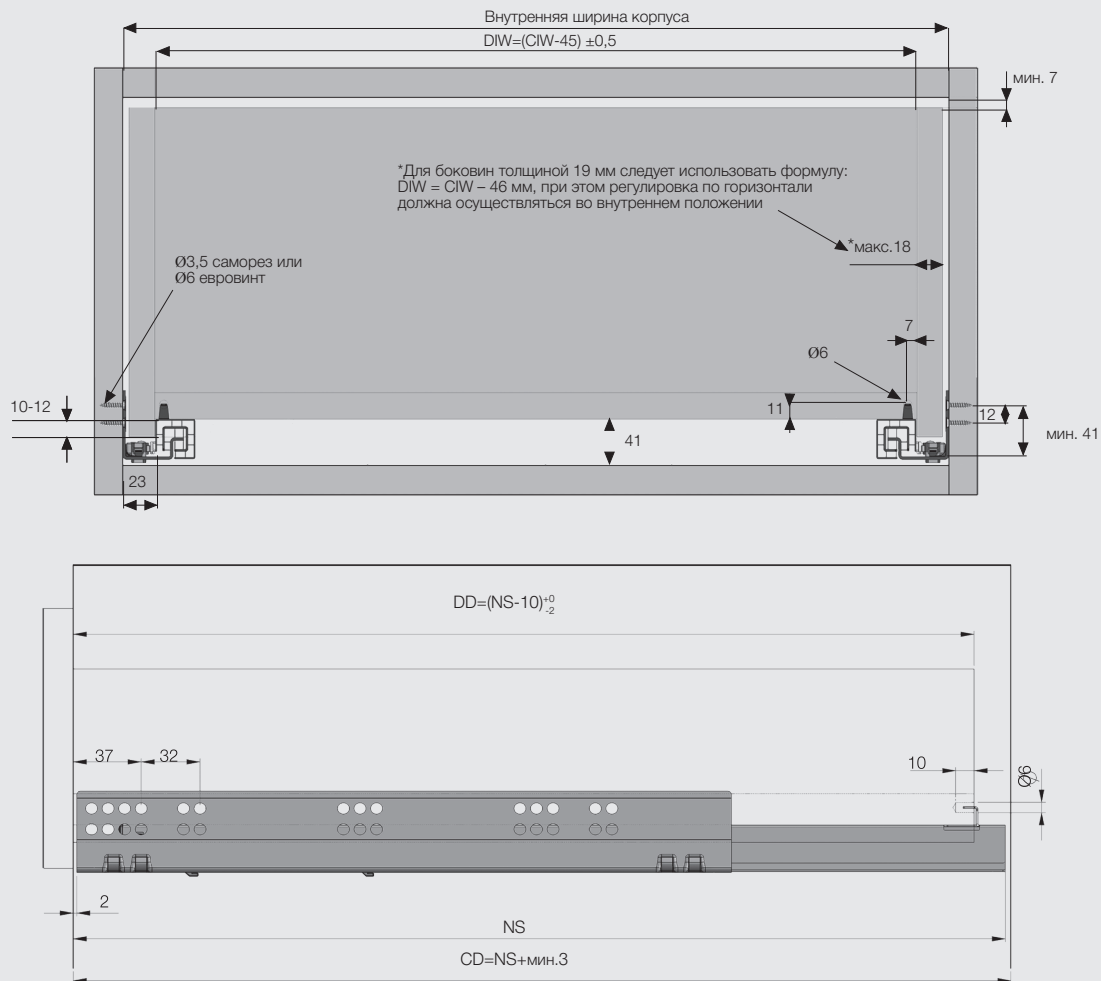

CD – Глубина корпуса
 CIW – Внутренняя ширина корпуса
 NS – Номин. размер
 DIW – Внутренняя ширина ящика
 DD – Глубина ящика

* Все размеры, указанные на чертежах, приведены в мм.

Рекомендуемые виды крепежа для установки направляющих

Саморез Ø3,5 x 16 мм



Евровинт Ø6,1 x 11,5 мм



Расположение винтов для направляющих

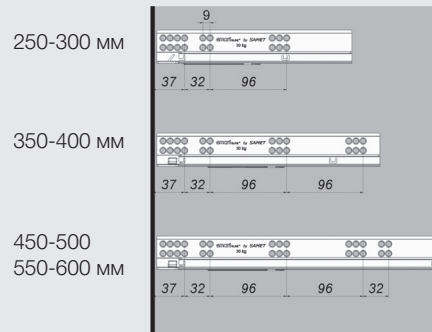

Kabin Ölçüleri
Cabinet Dimensions

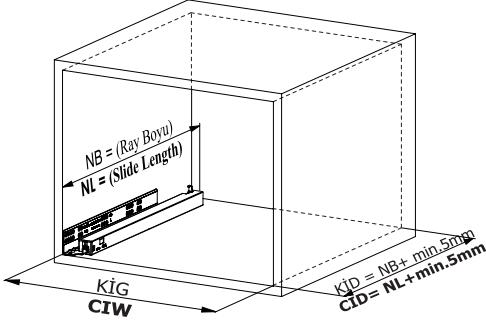

Kabin İç Geniřlięi	: KİG	Cabinet Internal Width	: CIW
Kabin İç Derinlięi	: KİD	Cabinet Internal Depth	: CİD
Çekmece Derinlięi	: ÇD	Drawer Depth	: DD
Çekmece İç Geniřlięi	: ÇİG	Drawer Internal Width	: DİW
Nominal Boy (Ray boyu): NB		Nominal Length	: NL

Tavsiye Edilen Vida ve Şablonlar
Recommended Screw and Templates

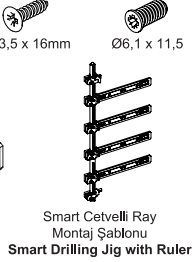
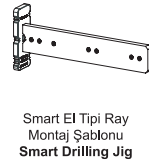
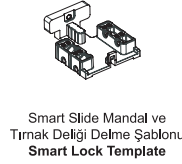
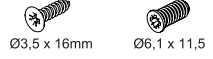

Rayların Vida Konum Ölçüleri
Screw Location for the Slides

Rayı, koyu renk ile işaretlenmiş deliklerden vidalayınız.
Screw the slide from marked holes.

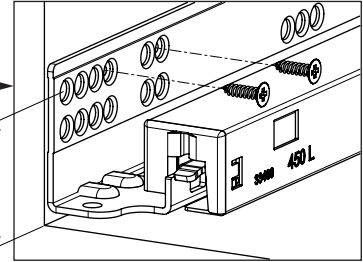
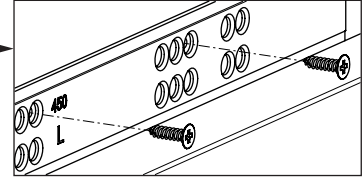
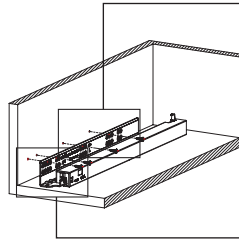
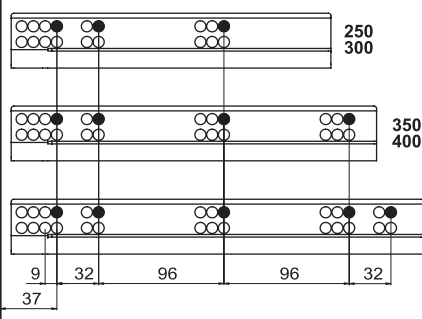

Çekmece Ölçüleri
Drawer Dimensions

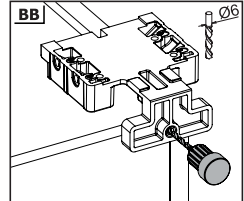
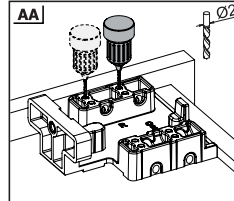
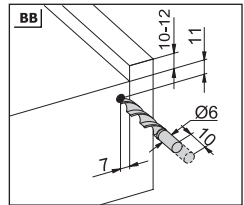
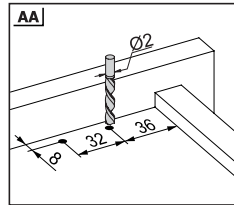
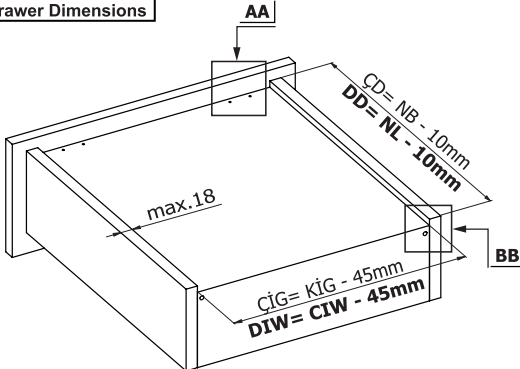

1

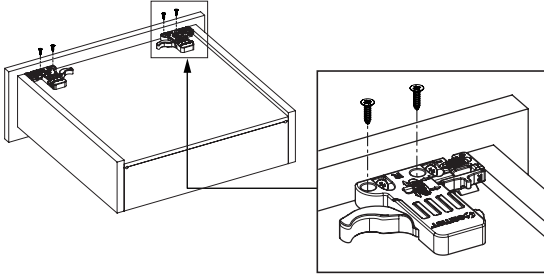

Not: Çekmece taban kalınlığı 12 mm'den küçük olduğunda, açılı mandal bağlama deliklerini kullanınız.

Note: Use angled holes to mount smart lock when wooden floor width is selected less than 12 mm.

AA

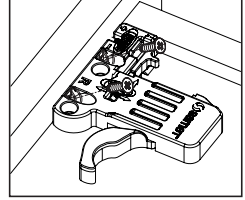
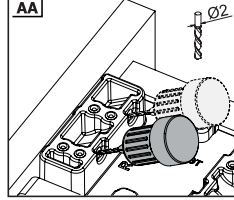

2

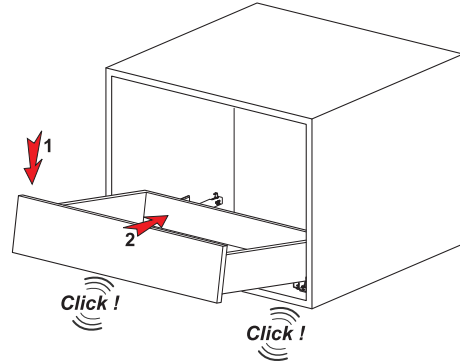

3

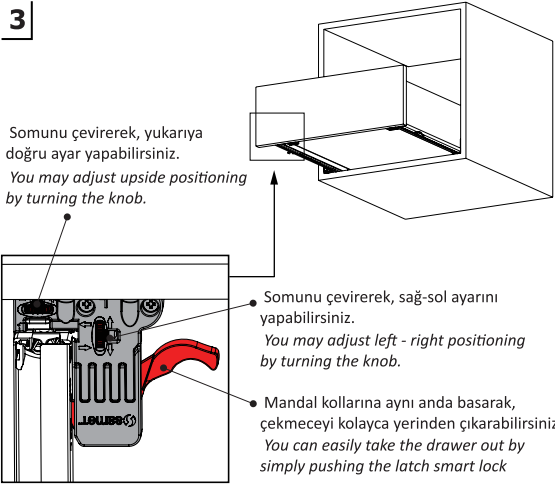

Smart El Tipi Ray
Montaj Şablonu
Smart Drilling Jig

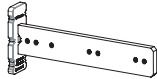

Kod / Code

12799902

12799904

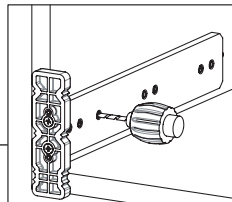
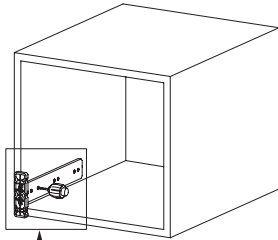

Smart Cetveli Ray
Montaj Şablonu
Smart Drilling Jig with Ruler

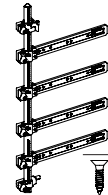

Kod / Code

12799901

12799905

